

LIGHT GUIDE KITS FOR IREX OPTICAL DETECTORS

DESCRIPTION

The light guides are optical fibers that carry light across its length from the protected hazard to the IREx detector. The IREx detector mounted on the light guide will react to differences of the received radiant energy caused by flames.

The light guide can be used where multiple sampling points are required by use of the triple light guide. Light guides can also be used in processes where the operating temperature exceeds the limitation of the IREx detector and for process areas that are difficult to reach.

Process connectors are available with an air purge to keep the connection to the process clean during operation, ensuring the timely detection of an explosion in processes where product build-up can be expected.

FEATURES AND BENEFITS

- Wide viewing angle
- High pressure and temperature rating
- Multiple sampling points with one IREx detector
- Corrosion resistance
- Simple IREx detector replacement
- Optional air purge for lens cleaning during operation

SPECIFICATIONS

Process Connection:	12.5 mm connector	7 mm connector
Light Transfer Principle:	Optical fibers	
Deflagration Overpressure:	174 psig (12 bar)	
Wetted Parts:	1.4404 (316L SST) Epoxy EPO-TEK® 353ND	
Temperature Range:	-4 to 500°F (-20 to +260°C)	

FIBER OPTIC LIGHT GUIDE KITS

Single Light Guide Kits	
Part Number	Description
E61-067-1	Single Light Guide 0.5 Meter Cable, Optical Detector Flange, Tri-Clamp, PTFE Gasket, Mounting Bracket
E61-067-2	Single Light Guide 1.0 Meter Cable, Optical Detector Flange, Tri-Clamp, PTFE Gasket, Mounting Bracket

Note- The single light guide cable mounting kit requires one process connection ordered separately.

Triple Light Guide Kits	
Part Number	Description
E61-068-1	Triple Light Guide 1.5 Meter Cable, Optical Detector Flange, Tri-Clamp, PTFE Gasket, Mounting Bracket
E61-068-2	Triple Light Guide 2.0 Meter Cable, Optical Detector Flange, Tri-Clamp, PTFE Gasket, Mounting Bracket

Note- The triple light guide cable kit requires three process connections ordered separately.

The single and triple light guide kits include all mounting hardware to connect to the IREx detector. Process connectors must be ordered separately.



Single Light Guide
Detector sold separately



Triple Light Guide
Detector sold separately

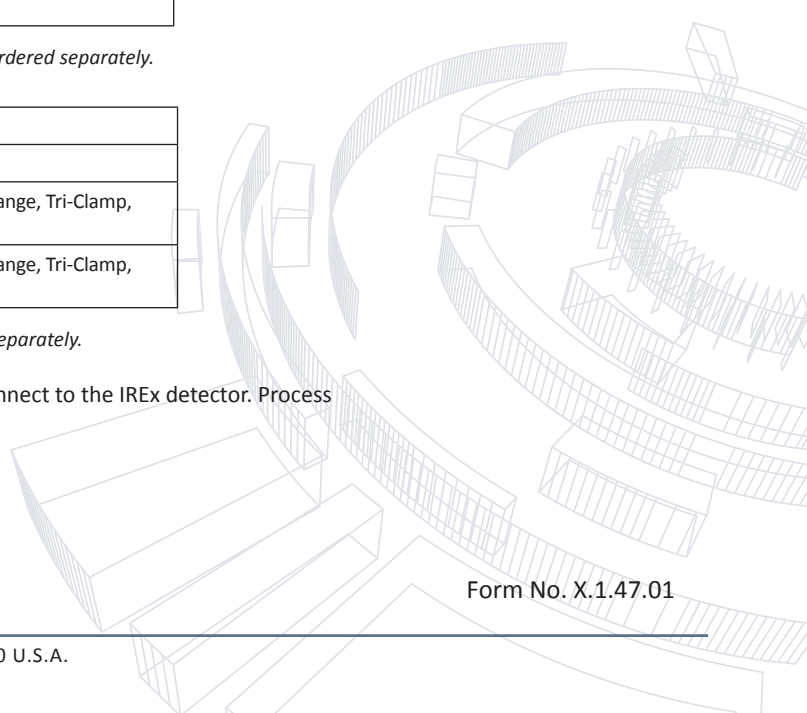

LIGHT GUIDE PROCESS CONNECTORS

Process connectors are ordered separately and are required for each application. Process connectors are made from 316L stainless steel and can be ordered with or without air purge.

Part Number	Description
23650531	Single Light Guide Process Connector 316L SST
23650331	Single Light Guide Process Connector with Air Purge 316L SST
23615631-S*	Triple Light Guide Process Connector 316L SST
23628431-S*	Triple Light Guide Process Connector with Air Purge 316L SST

* Triple light guide process connectors are sold individually. Three are required per triple light guide kit.

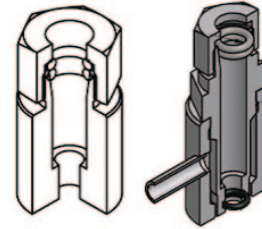

Process Connectors